

THIS DRAWING has been prepared by the Architect, or prepared under his direct supervision as an instrument of service and is intended for use only on this project. All Drawings, Specifications, Notes and details, including the overall layout, form, arrangement, and construction of space and elements portrayed, constitute the original, unpublished work of the Architect. Any reproduction, use, or disclosure of the information contained herein without the written consent of the Architect is strictly prohibited.

© 2016 KLOVER ARCHITECTS, INC.

THE ARCHITECT DISCLAIMS responsibility for the existing building structure, site conditions, existing construction elements, or any documents, drawings or other instruments used for any part of this Project which do not bear the Architect's seal. The Architect's services are rendered only in the interest of the Project owner. No obligation is assumed by the Architect for the benefit of any other entity.

RELATED DOCUMENTS: The Drawing is a single component of an integrated set of Construction Documents. General and Supplementary Conditions of the Contract, General Instructions, Specifications and other drawings may affect the final outcome. Failure to review and integrate the entire set of the Construction Documents does not release the Contractor from providing a complete Project.

COMPLY WITH all laws, codes, ordinances and regulations with authorities having jurisdiction and with requirements of the Landmark, if applicable. Do not start field work until all permits and required approvals are obtained.

VERIFY ALL ACTUAL CONDITIONS and dimensions prior to construction. Commitment of work constitutes verification and acceptance of all existing conditions. Verification of a material or measured item is that indicated by others constitutes acceptance of that item, and assumption of responsibility for satisfactory installation.

INDICATING SHOWN on to field face of a material unless otherwise indicated. CURBLINE & BERMLINE dimensions - DO NOT SCALE drawings unless otherwise directed.

project title

MISSION TRAILS

JOHNSON DRIVE  
MISSION, KS

project number  
17042.001

drawing issuance  
PDP SUBMITTAL 04.10.17

drawing revisions  
No. Description: Date:  
1 CITY COMMENTS 5/12/17

professional seal

drawing title  
PRELIMINARY LANDSCAPE PLAN

drawing number  
L100

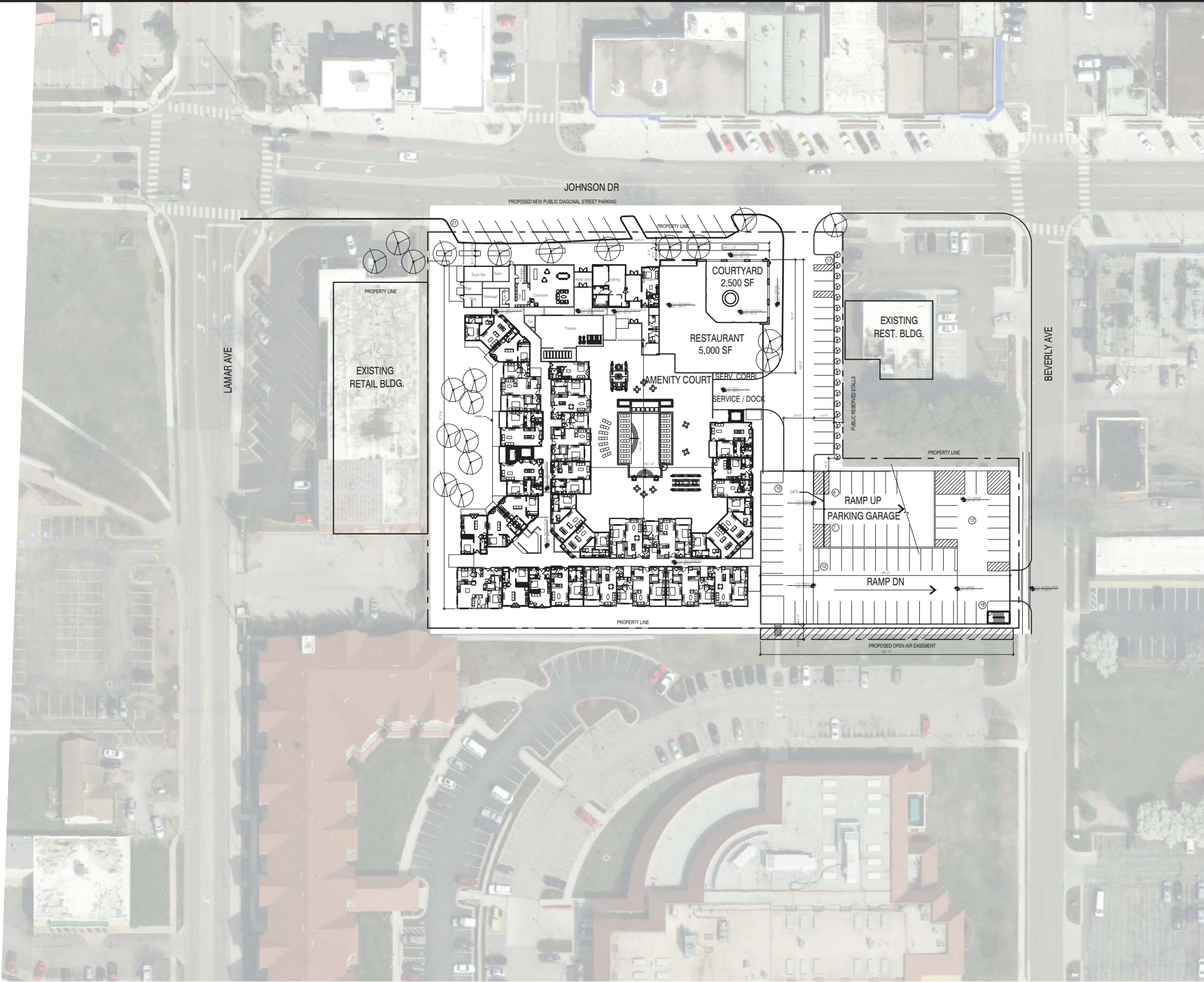

SITE DATA	
SITE ACREAGE:	2.820
5 STORY BUILDING WOOD FRAMING ON PODIUM	
TOTAL UNITS:	200
RESTAURANT:	5,000 SF
COMMERCIAL:	5,000 SF
RESIDENTIAL:	203,125 SF
TOTAL SF:	213,125 SF
COURTYARD NOT INCLUDED: 2,500 SF	
PARKING REQUIRED:	
200 UNITS	= 225 STALLS
@ 1 PER 1 BED & 1.5 PER 2 BED	
RETAIL / REST. PARKING	
@ 10 PER 1000SF	
= 50 STALLS	
TOTAL REQ:	
275 STALLS	
PARKING PROVIDED:	
SURFACE STALLS:	38 STALLS
GARAGE STALLS:	287 STALLS
TOTAL PARKING:	
325 STALLS	
PARKING GARAGE BREAKDOWN:	
OPEN GARAGE PARKING:	52 STALLS
APARTMENT PARKING:	235 STALLS

THIS DRAWING has been prepared by the Architect, or prepared under his direct supervision as an instrument of service and is intended for use only on this project. All drawings, specifications, plans and designs, including the overall layout, form, arrangement, and composition of spaces and elements portrayed, constitute the original, unpublished Work of the Architect. Any reproduction, use, or disclosure of the information contained herein without the written consent of the Architect is strictly prohibited.

© 2016 KLOVER ARCHITECTS, INC.

THE ARCHITECT DISCLAIMS responsibility for the existing building structure, site conditions, existing construction elements, or any documents, drawings or other instruments used for any part of this Project which do not bear the Architect's seal. The Architect's services are undertaken only in the interest of the Project Owner. No obligation is assumed by the Architect for the benefit of any other entity.

RELATED DOCUMENTS: This drawing is a single component of an integrated set of Construction Documents. General and Supplementary Conditions of the Contract, General Requirements, Specifications and other documents may affect the Work described. Failure to review and integrate the design intent of the whole of the Construction Documents does not relieve the Contractor from providing a complete Project.

COMPLY With all laws, codes, ordinances and regulations with authorities having jurisdiction and with requirements of the landowner. It is the responsibility of the Contractor to obtain all necessary permits and approvals. Do not start Work until all permits and required approvals are obtained.

VERIFY ACTUAL CONDITIONS and dimensions prior to construction. Commencement of work constitutes verification and acceptance of all existing conditions. Application of a material or equipment item to Work installed by others constitutes acceptance of that Work, and assumption of responsibility for satisfactory installation.

DIMENSIONS SHOWN are to finish face of a material unless otherwise indicated. OBTAIN & VERIFY dimensions - DO NOT SCALE drawings unless otherwise directed.

project title

MISSION TRAILS  
JOHNSON DRIVE  
MISSION, KS

project number  
17042.001  
drawing issuance  
PDP SUBMITTAL 04.10.17  
drawing revisions  
No. Description: Date:  
PDP RESUBMITTAL 05.12.17

professional seal

drawing title  
ARCHITECTURAL  
SITE PLAN  
drawing number

AS100



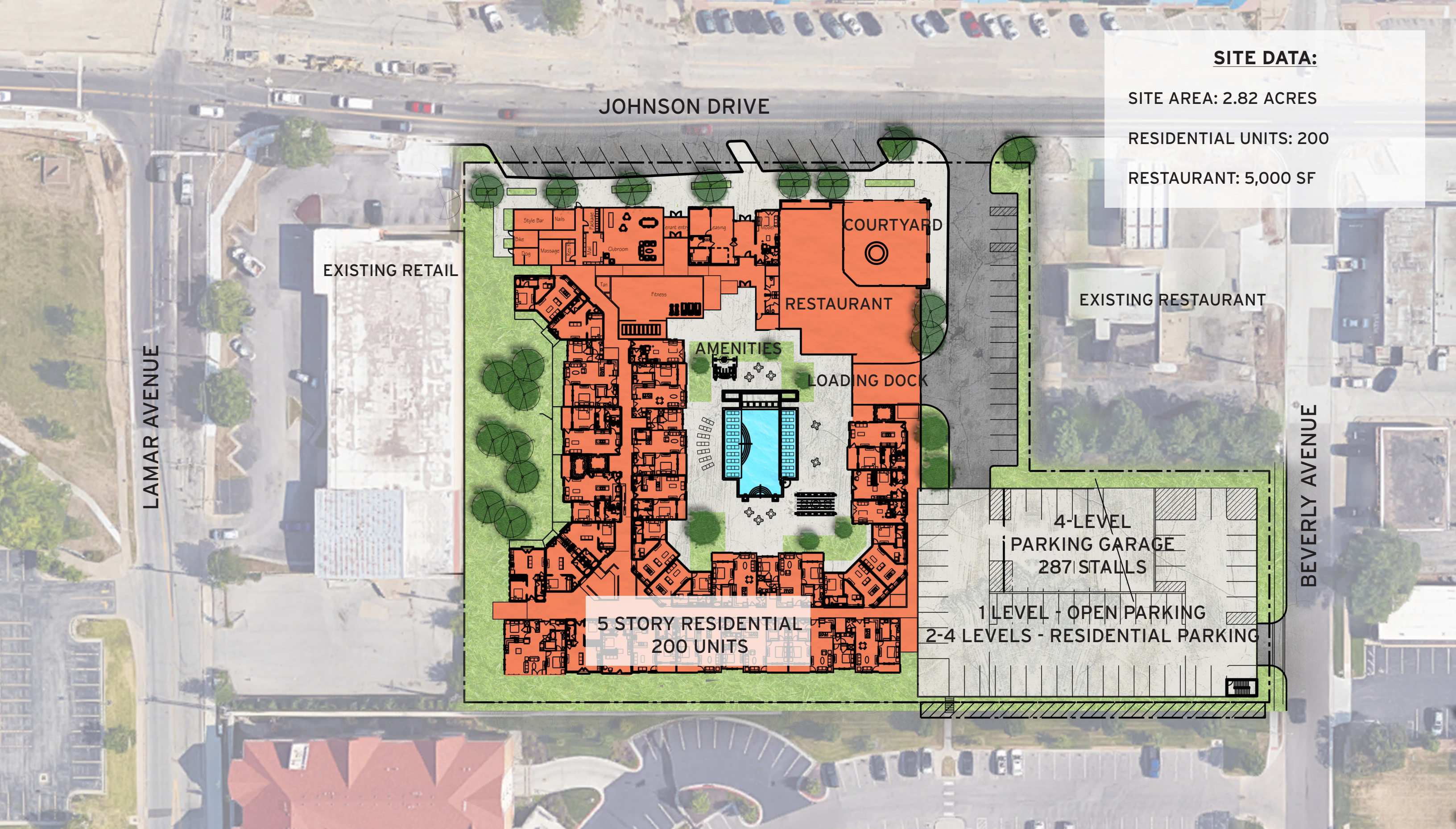

COLORED SITE PLAN



VIEW 1



VIEW 2



VIEW FROM MARTWAY ST



VIEW FROM BEVERLY AVE LOOKING WEST



VIEW FROM LAMAR AVE



VIEW FROM BEVERLY AVE LOOKING NORTHWEST



TOP OF TOWER	63'-0"
ROOF LINE	55'-0"
FIFTH FLOOR	43'-6"
FOURTH FLOOR	33'-0"
THIRD FLOOR	22'-6"
SECOND FLOOR	12'-0"
GROUND FLOOR	0'-0"

EAST ELEVATION



TOP OF TOWER	63'-0"
ROOF LINE	55'-0"
FIFTH FLOOR	43'-6"
FOURTH FLOOR	33'-0"
THIRD FLOOR	22'-6"
SECOND FLOOR	12'-0"
GROUND FLOOR	0'-0"

NORTH ELEVATION



WEST ELEVATION



SOUTH ELEVATION



VISION IMAGES



## VISION IMAGES



VISION IMAGES